

## Elite Optima: Diagnosing speaker issues.

If chair is received and there is no sound at all:

1. Check that your music source is completely plugged into the audio cable and the music source is turn up high.



2. Check the audio cable is completely plugged into the connector at the back right rear frame.

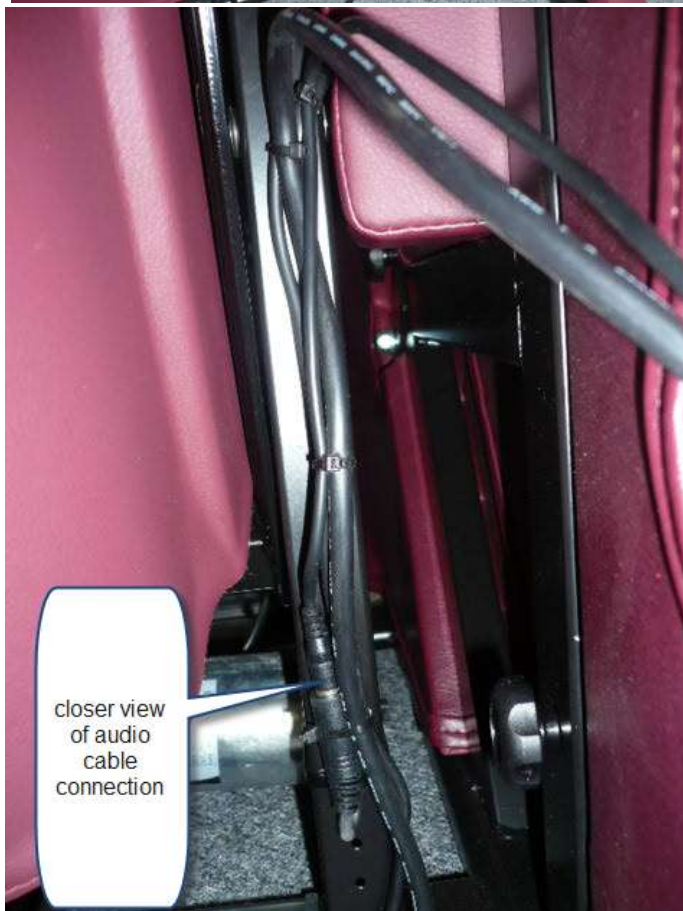

3. Check the speaker connection from the backrest to the speakers beneath the back pad cushion.



4. Check the speakers using voltage meter

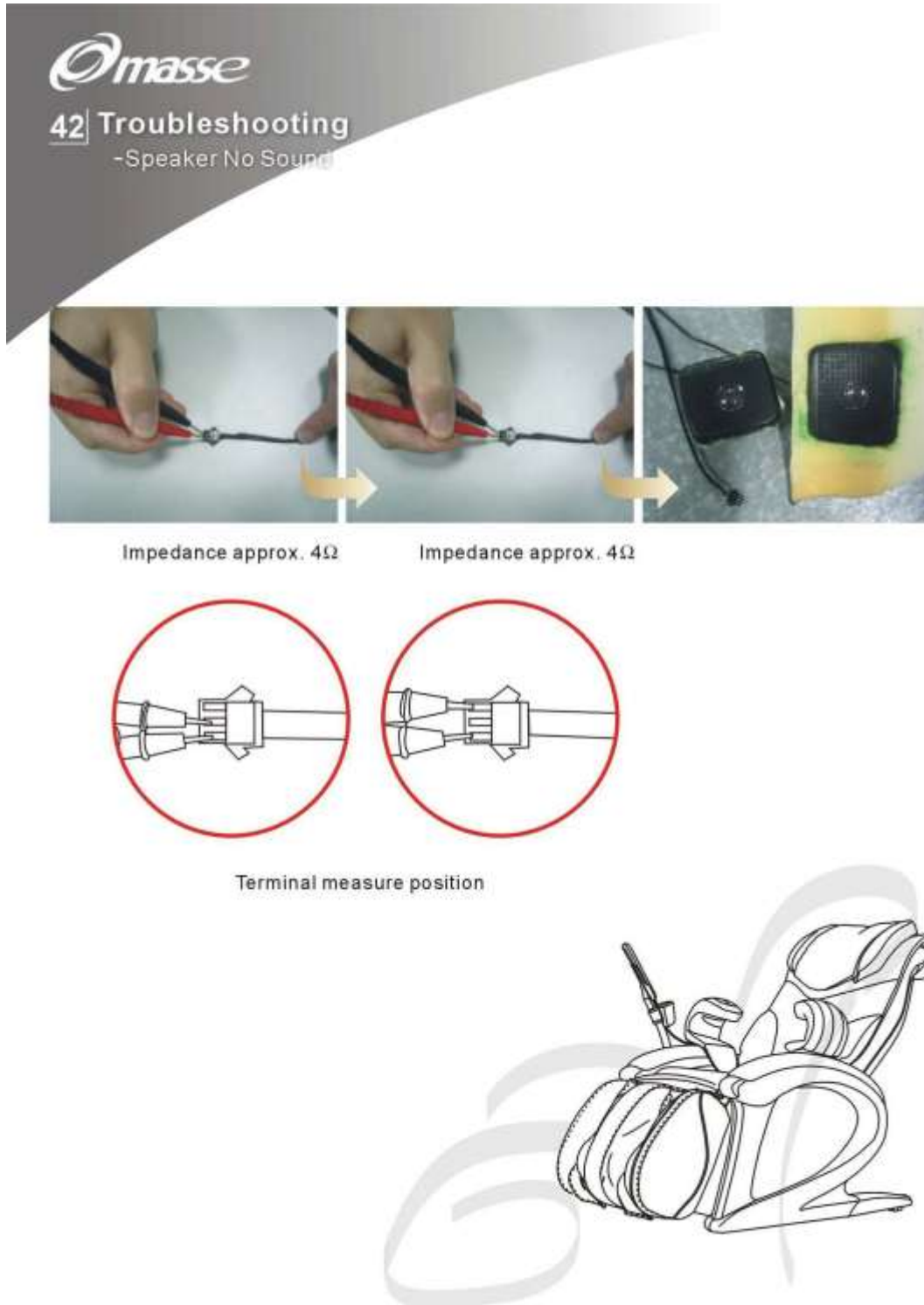

If speakers crackle and make noise even if no music source is connected then the music board should be replaced.